



COB LED STRIP

## CB-PRO-24V-5M-8MM

### Feature

- Highlight COB + flexible FPC for superior flexibility and light quality.
- High colour rendering with CRI90+ for more accurate and vivid lighting.
- Delivers high brightness with light efficiency up to 115 lm/W.
- Precise cutting every 50mm for customizable lengths.
- Wide waterproofs range from IP20 to IP67 for various environments.
- Long lifespan of  $\geq 50,000$  hours for extended use.
- Compatible with a wide range of dimming controllers.
- Available in multiple colour temperatures: 2700K, 3000K, 4000K, 6500K.
- Operates on safe low voltage (24V DC) with wide beam angle ( $180^\circ$ ).
- Designed to perform reliably in  $-20^\circ\text{C}$  to  $+45^\circ\text{C}$  conditions.

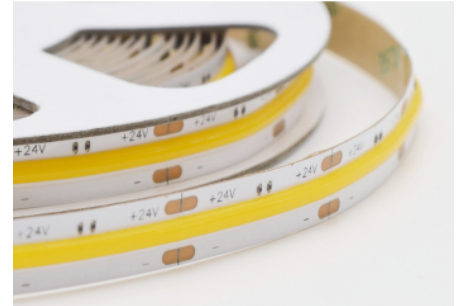

### Application

Ideal for energy-efficient, flexible, and multifunctional home and commercial lighting such as:

- Under-cabinet and shelf lighting
- Cove and indirect ceiling lighting
- Stair and corridor lighting
- Display and showcase illumination
- Decorative architectural accents
- Moist or outdoor spaces requiring waterproof protection

## Specification

Part No.	Dimension	Colour	Style	Voltage	Power	Brightness	CRI	Increment	Max Run	IP Rating	Beam Angle
CB-PRO-24V-5M-8MM-27K	L5,000 x W8 x H1.6mm	2700K	COB	24Vdc	15 W/m	1,418 lm/m	$\geq 90$	50 mm	5m	IP20	$180^\circ$
CB-PRO-24V-5M-8MM-40K	L5,000 x W8 x H1.6mm	4000K	COB	24Vdc	15 W/m	1,700 lm/m	$\geq 90$	50 mm	5m	IP20	$180^\circ$
CB-PRO-24V-5M-8MM-65K	L5,000 x W8 x H1.6mm	6500K	COB	24Vdc	15 W/m	1,675 lm/m	$\geq 90$	50 mm	5m	IP20	$180^\circ$

## Dimension

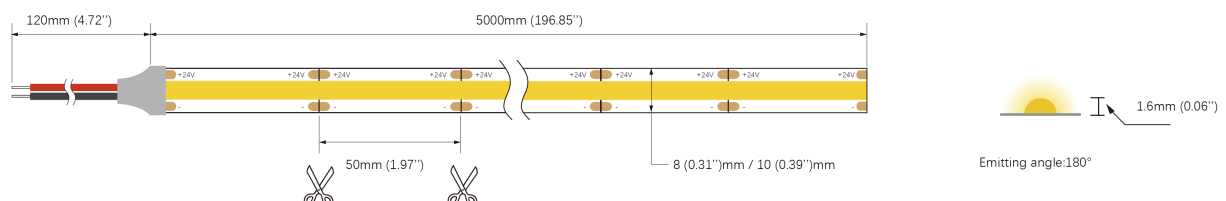

## Spectroscopic Data

### Spectroscopic date

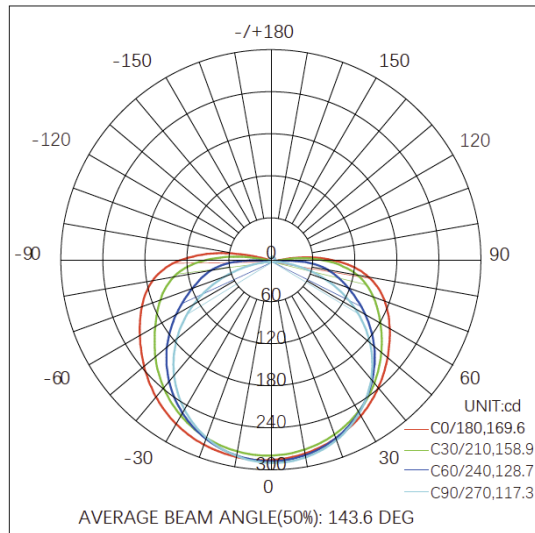

**Remark:** Output data is from test result of 4000K strip light ;  
Tolerance +10%.

Flux out: 713.7 lm

Height	Eavg, Emax	Angle:117.30 deg	Diameter
1m	82.02,293.0 lx		328.33 cm
2m	20.50,73.24 lx		656.66 cm
3m	9.113,32.55 lx		984.99 cm
4m	5.126,18.31 lx		1313.31 cm
5m	3.281,11.72 lx		1641.64 cm
6m	2.278,8.138 lx		1969.97 cm
7m	1.674,5.979 lx		2298.30 cm
8m	1.282,4.578 lx		2626.63 cm
9m	1.013,3.617 lx		2954.96 cm
10m	0.8202,2.930 lx		3283.29 cm

Height Eavg,Emax Angle:117.30 deg Diameter

## Installation

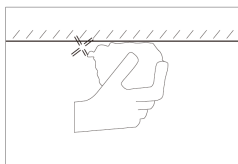

1. Clean application space.

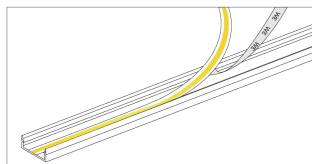

2. Peel off paper of 3M tape from solder side and then stick on application.

IP20/IP55/IP66

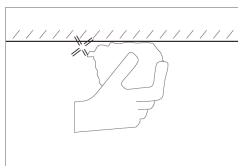

1. Clean application space.

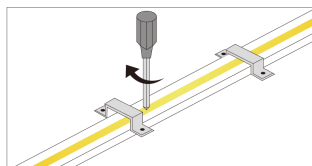

2. Fix LED strip with clip.

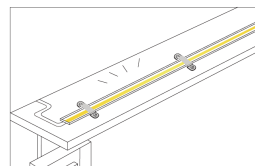

3. Electrify.

IP65/IP67

## Document Revision

Revision	Description	Date	Author	Approver
1.0	Initial release	4 September 2025	Jesse Jankelowitz	Michael Xu